

Mechanical Dimensions: Inches [mm]

Tolerances ± 0.012 [0.3] Unless Otherwise Specified

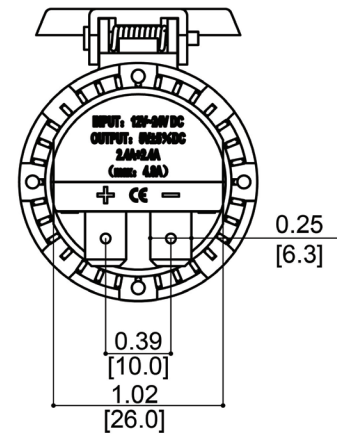
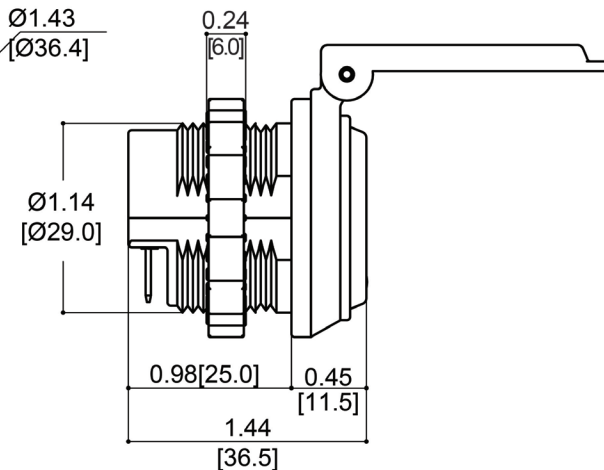
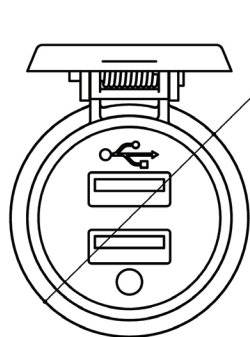
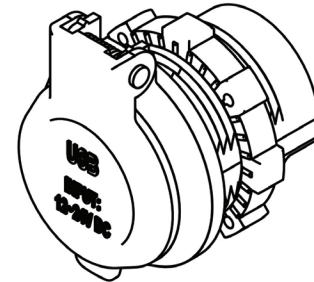
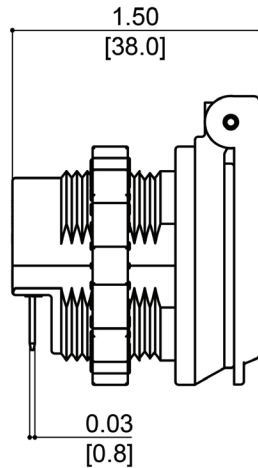
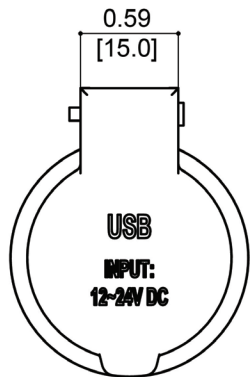

Electrical Specifications

Nominal Voltage	12/24VDC
Operating Voltage	12V/30VDC (max)
Peak Voltage	32VDC (max) (3~4 sec)
Output Rating (12VDC Input)	Type A Output 1 (5V; 2.4A) Type A Output 2 (5V; 2.4A) Type A + Type A (5V 2.4A + 5V 2.4A)
Output Rating (24VDC Input)	Type A Output 1 (5V; 2.4A) Type A Output 2 (5V; 2.4A) Type A + Type A (5V 2.4A + 5V 2.4A)
Operating Frequency	100~150Khz
Current Draw	20mA
Operating Temperature	-20 °C ~ 60 °C

Material Specifications

Two Type A USB Connections	
Terminals Material	Brass
Body Material	Reinforced Nylon
Mounting Hole	29mm diameter
LED Power Indicator	
Ingress Protection	IP65 when (When not in use and cap is securely closed)

Rev Date of issue Revision Notes

Designed Approved

B	02-14-2025	Initial Drawing	RC	OF
---	------------	-----------------	----	----